

# BOXER-6647-MTH PRELIMINARY

Fanless Compact Embedded Computer with Intel® Core™ Ultra 7/5 Processors

Front View

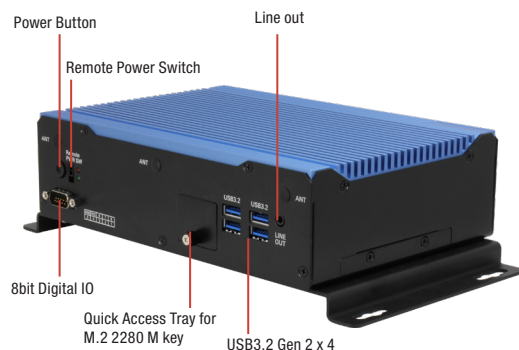

Rear View

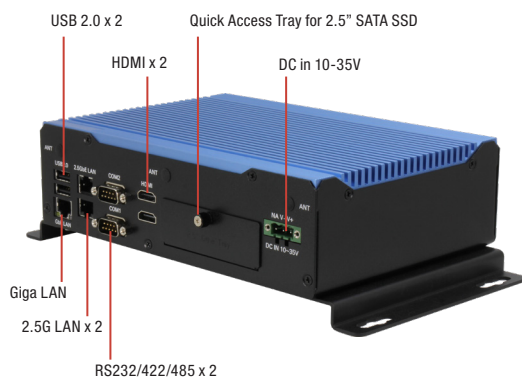

## Features

- Intel® Core™ Ultra 5/7 Processor
- DDR5 4800 SODIMM x 2, up to 64GB
- Accessible M.2 2280 NVMe SSD Tray + 2.5" SSD Tray
- M.2 3052 B-Key for 5G
- USB 3.2 Gen 2 (Type-A) x 4
- Onboard TPM 2.0
- Wide 9V ~ 36V DC Input Range
- Wide -20°C ~ 70°C Operating Temperature



## Specifications

System	
CPU	Intel® Core™ Ultra 5 processor 125H Intel® Core™ Ultra 7 processor 155H
Chipset	Intel® SoC
System Memory	DDR5 4800 MT/s SO-DIMM slot x 2, up to 64GB
Display Interface	HDMI x 2 (Support 4K @60Hz)
Storage Device	M.2 2280 M-Key x 1 (NVMe PCIe SSD, quick access tray design) 2.5" SATA HDD/SSD x 1 (quick access tray design)
Ethernet	RJ-45 x 2 for 2.5GbE LAN (Intel® Ethernet Controller I226) RJ-45 x 1 for GbE LAN (Intel® Ethernet Connection I219)
I/O	HDMI x 2 USB 3.2 Gen 2 (Type-A) x 4 USB 2.0 (Type-A) x 2 DB-9 Male x 2 for RS-232/422/485 Line out x 1 D-Sub Male Connector x 1 for 8-bit DIO DC 9V ~ 36V 3-pin Terminal Block Connector Remote Power x 1 Power Button with LED x 1
Expansion	M.2 2280 M-Key x 1 (PCIe [x4] for NVMe Storage) M.2 2230 E-Key x 1 (for Wi-Fi) M.2 3052 B-Key x 1 (for 5G/LTE) SIM Slot x 1
Indicator	Sys LED Storage active LED
OS support	Windows® 10 IoT Enterprise, Windows® 11 Pro, Windows® 11 IoT Enterprise, Linux Ubuntu 22.04
Power Supply	
Power Requirement	8.66" x 6.06" x 2.42" (220mm x 154mm x 62.1mm) w/o bracket 10.7" x 6.1" x 3.0" (272mm x 154mm x 76.1mm) with bracket
Mechanical	
Mounting	Wallmount
Dimensions (W x H x D)	8.66" x 6.06" x 2.42" (220 mm x 154 mm x 62.1 mm) w/o bracket
Gross Weight	6.6 lbs. (3.2 kg)
Net Weight	4.9 lbs. (2.4 kg)
Environmental	
Operating Temperature	-4°F ~ 158°F (-20°C ~ 70°C), IEC68-2 with 0.7 m/s AirFlow, with wide temperature Memory/Storage
Storage Temperature	-40°F ~ 176°F (-40°C ~ 80°C)
Storage Humidity	5 ~ 95% @ 40°C, non-condensing
Anti-Vibration	3 Grms/ 5 ~ 500Hz/ operation (with SSD)
Anti-Shock	50G, IEC 68-2-27, half sine, 11 ms duration (with SSD)
Certification	CE/FCC class A

### Dimension

Unit: mm

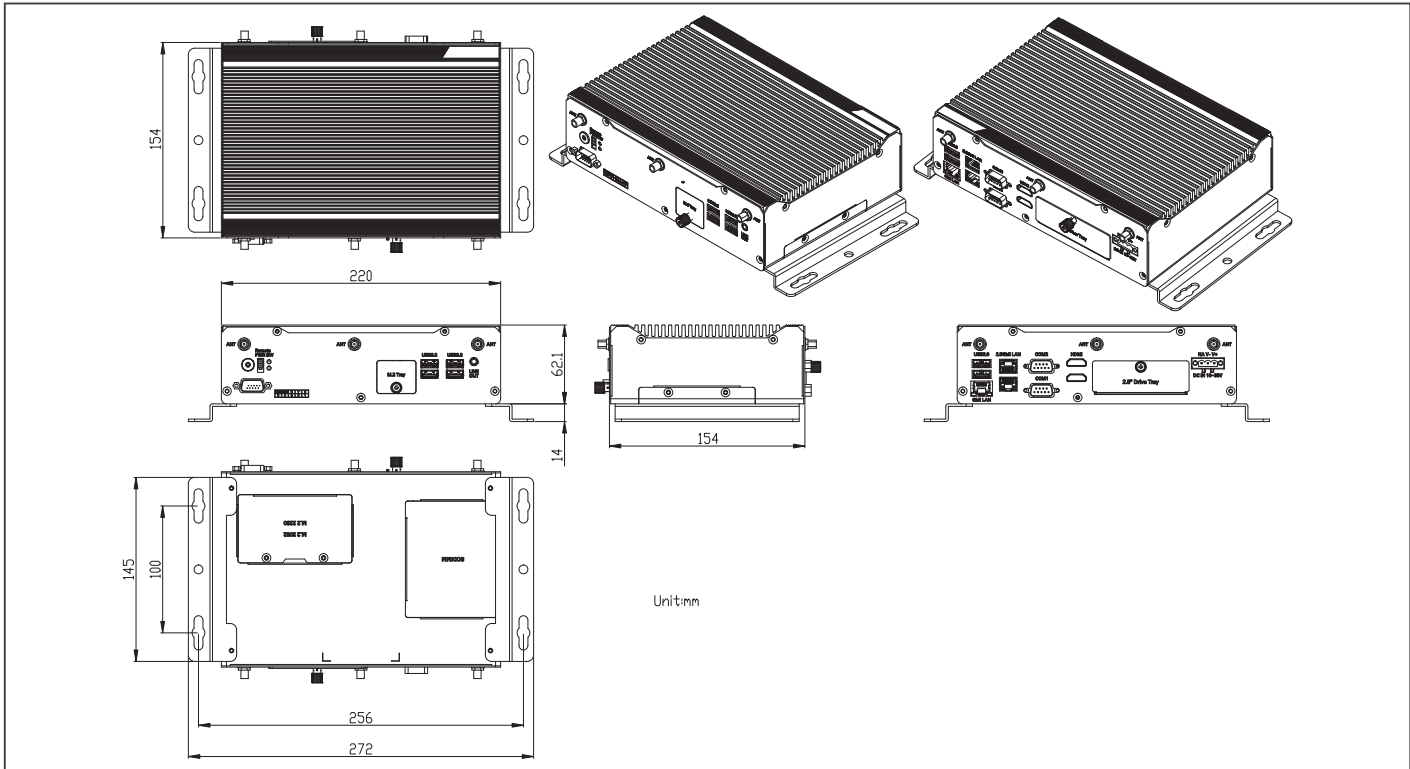

### Ordering Information

Part Number	CPU	LAN	PCH	USB 3.2 Gen2	USB 2.0	RS232/422/485	Storage	Display	Expansion	Mounting	Power	Operation Temp.
BOXER-6647-MTH-A1-1010	Intel® Core™ Ultra 5 processor 125H	3	Intel SoC	4	2	2	M.2 2280 M Key Slot x 1 (NVMe SSD) 2.5" SATA Drive Bay x 1	HDMI x 2	M.2 2230 E Key x 1 M.2 3052 B Key x 1 SIM Slot x 1	Wallmount	9~36V DC in	-4°F ~ 158°F (-20°C ~ 70°C), according to IEC68-2 with 0.7 m/s AirFlow (w/ Industrial wide Temp. SSD/RAM) SSD: -20 ~ 85C RAM: -20 ~ 95C
BOXER-6647-MTH-A2-1010	Intel® Core™ Ultra 7 processor 155H	3	Intel SoC	4	2	2	M.2 2280 M Key Slot x 1 (NVMe SSD) 2.5" SATA Drive Bay x 1	HDMI x 2	M.2 2230 E Key x 1 M.2 3052 B Key x 1 SIM Slot x 1	Wallmount	9~36V DC in	-4°F ~ 158°F (-20°C ~ 70°C), according to IEC68-2 with 0.7 m/s AirFlow (w/ Industrial wide Temp. SSD/RAM) SSD: -20 ~ 85C RAM: -20 ~ 95C

### Packing List

- BOXER-6647-MTH

### Optional Accessories

- TBD